



PRO™

power
up Academy

F-150® Lightning® Truck:

How to Use Pro Power Onboard™

For Drivers



Overview

This segment teaches drivers how to operate **Pro Power Onboard**,¹ which consists of **power outlets** conveniently located in the **frunk, cab and cargo bed** of your F-150[®] Lightning[®] truck. It also provides some ideas for **what sorts of equipment and devices you can power** with the system.

1. See Owner's Manual for important operating instructions. Computer-generated image shown.



Pro Power Onboard™ Comes Two Ways

- ▶ Look in the truck's **cargo bed** to see which system is on your F-150® Lightning® model. If you see **3 power outlet covers** (shown), it has the available **9.6kW system**. If you only see **1 cover**, then it's the **2.4kW system**.
- ▶ Each system is made up of several power outlets.
 - ▷ **9.6kW system:** 120V outlets (4 in the frunk, 2 in the cab, 4 in the cargo bed) and a 240V outlet in the bed
 - ▷ **2.4kW system:** 120V outlets (4 in the frunk, 2 in the cab, 2 in the cargo bed)

The System Must Be Turned On

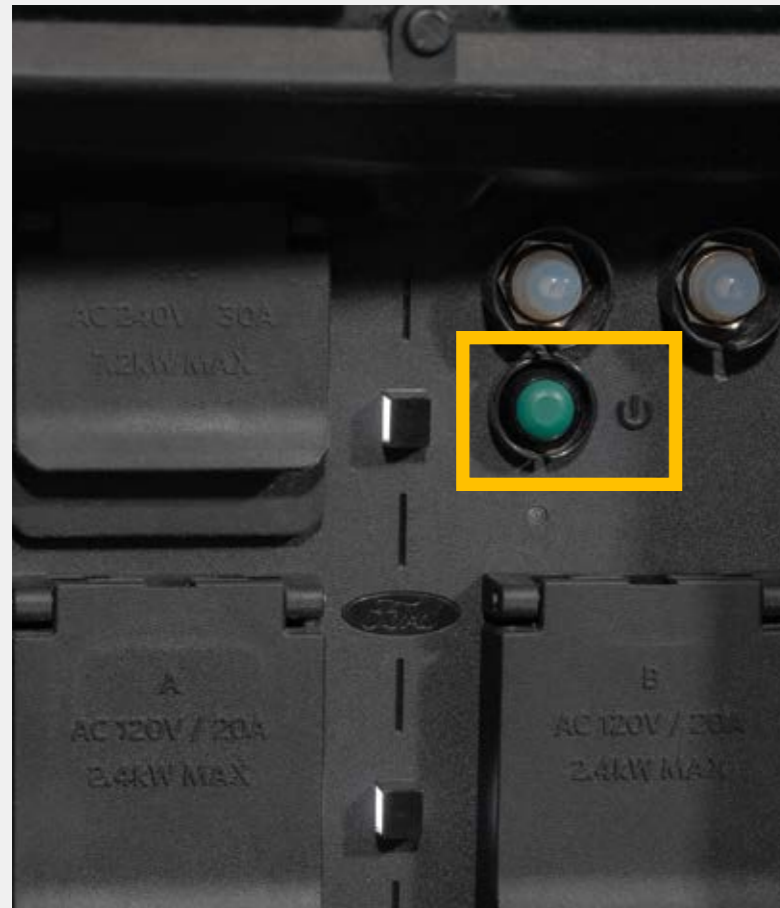

- ▶ When your electric vehicle (EV) is already on, you can **activate the outlets** 2 ways:
 - ▷ Press the **green button** near an outlet
 - ▷ On the **touchscreen**, tap **Features**, then select the **Pro Power Onboard™** tile, and press the **power** button
- ▶ If your EV is off, you'll need to **press the green button** near an outlet **within a minute** of exiting or unlocking the vehicle.
- ▶ An **indicator light** near the outlet illuminates when the system is on.

See Owner's Manual for important operating instructions.
Screens shown are subject to change.



It's Got Powerful Possibilities

- ▶ The system can **power several items at the same time**, spread across **all of the circuits**! Below are some examples:
 - ▷ **2.4kW system:** jackhammer and compact concrete mixer (2,300W total)
 - ▷ **9.6kW system:** 12" compound miter saw, circular saw, gang battery charger, hammer drill, 2.5-hp air compressor, and area floodlights (8,000W total)
- ▶ With Pro Power Onboard™, the F-150® Lightning® pickup with an Extended Range Battery **charged nightly** can support a worksite for a **16-hour shift**, every day.²

1. See Owner's Manual for important operating instructions. 2. See Owner's Manual for important operating instructions. Assumes typical worksite is 3-4 crew, meaning at maximum 4 tools can operate at one time, no worker operates more than one tool at a time, that tools are not used consistently without interruption.

Monitor Your Use on the Touchscreen



- ▶ The graphics on the **Pro Power Onboard™** screen show you **available power in Watts (W)** and the power **currently in use (white bars)**.
- ▶ Be sure devices you plug in **do not exceed** the available power (W).
- ▶ If you do exceed available power, the system **shuts down and displays a message** with instructions on screen.



Reserve Some Power for Driving

- ▶ Be sure to tell the system **how much battery range to save for driving** to where you can recharge.
 - ▷ This is called setting the **Pro Power Reserve**
 - ▷ When it's reached, the **system notifies you** on the touchscreen and **Pro Power Onboard™ turns off**
- ▶ You can keep the Pro Power Reserve at the **default setting of 70 miles**, change it to calculate the range to the nearest charging station, or manually set your preferred range.

Changing the Limit on Pro Power Reserve



- ▶ On the touchscreen, open the **Features** menu, then select the **Pro Power Onboard™** tile.
- ▶ Scroll down to **Pro Power Reserve**.
- ▶ **Increase or decrease** the range reserve manually by using the left and right arrows or slider bar.
- ▶ **And remember:** set the Pro Power Reserve with enough range to drive to a charger.



If a Device Exceeds the Power Limit

- ▶ The **system notifies you** on the touchscreen, the **outlet turns off**, and the indicator light flashes.
- ▶ To **reset** the outlet, you can **unplug the device** and turn the **vehicle off** to let the system cool and reset.
- ▶ When you turn the vehicle back on, check that the **outlet indicator light is on** (not flashing).

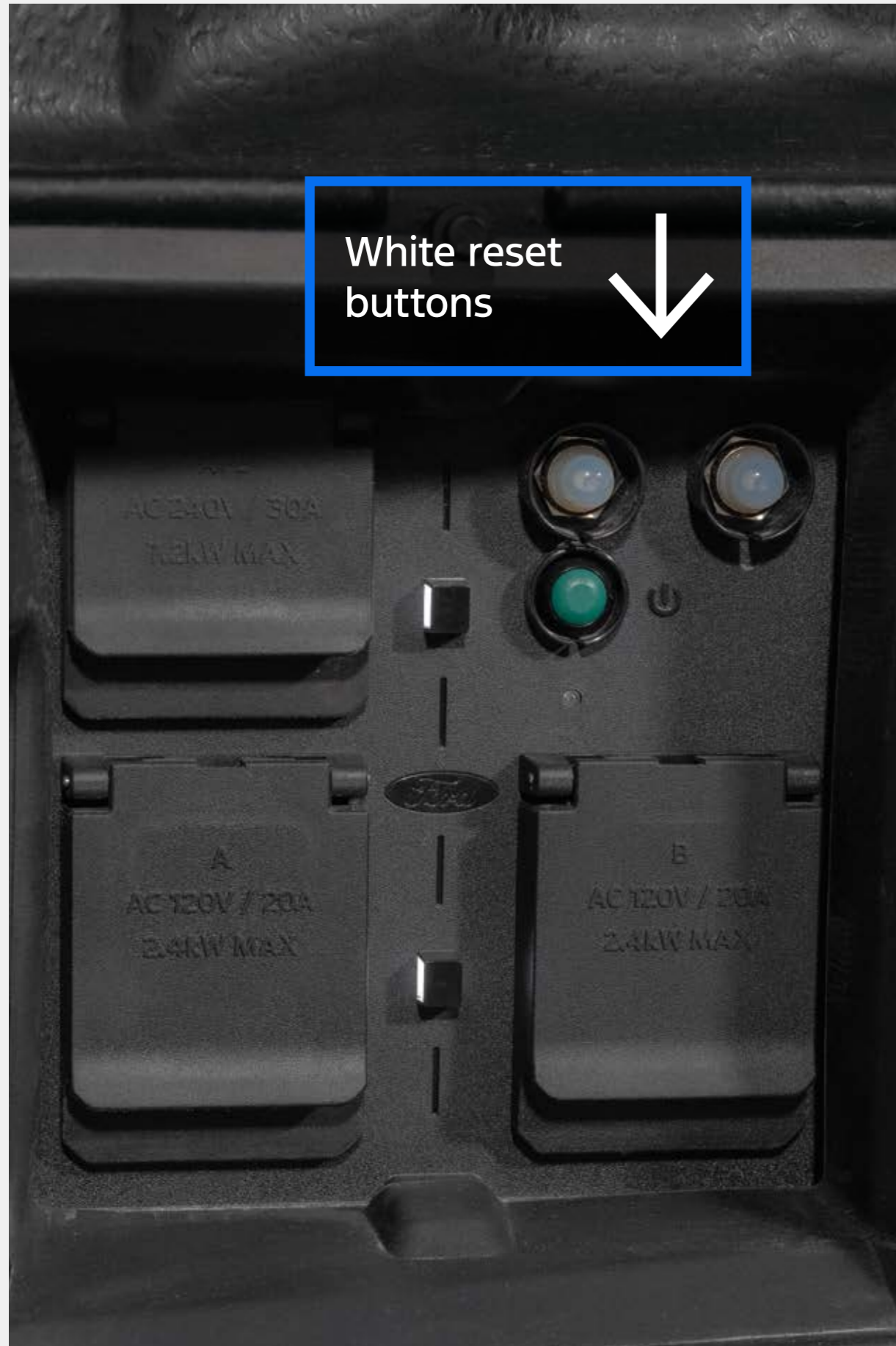

If the System Detects a Ground Fault

- ▶ You'll see a **message on the touchscreen**, and the **outlets will stop working**.
- ▶ To **reset** the system, you can:
 - ▷ **Unplug all devices**
 - ▷ **Reset the circuit breakers** through the **touchscreen** or by pressing the **white reset buttons** near the outlets **in the cargo bed**

©2025 Ford Motor Company. F-150 Lightning, Ford Pro and Pro Power Onboard are trademarks of Ford or its affiliates. All rights reserved.

Specifications and descriptions contained within are based on the most current information available at the time of release. Ford reserves the right to change product specifications, pricing, and equipment at any time without incurring obligations. Products shown may include optional features. PUADAT19